

### SKiM® 5 IGBT Module

### SKiM 400 GD 063 D

Preliminary Data

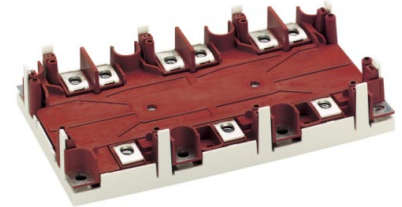

### SKiM 5

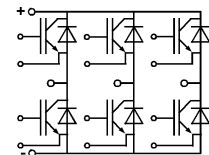

GD

### Features

- NPT-IGBT with positive temperature coefficient of  $V_{CEsat}$
- Short circuit, self limiting to  $6 \times I_C$
- Corresponds to standards IEC 60721-3-3 (humidity) class 3K7/IE32 and IEC 68T.1 (climate) 40/125/56

### Typical Applications

- Resonant inverters up to 100 kHz
- Inductive heating
- Electronic welders at  $f_{sw} > 20$  kHz

Absolute Maximum Ratings		$T_h = 25^\circ\text{C}$ , unless otherwise specified	
Symbol	Conditions	Values	Units
<b>IGBT</b>			
$V_{CES}$		600	V
$I_C$	$T_S = 25 (70)^\circ\text{C}$	420 (316)	A
$I_{CRM}$	$T_S = 25 (70)^\circ\text{C}$ , $t_p = 1$ ms	840 (632)	A
$V_{GES}$		$\pm 20$	V
$T_j$ , ( $T_{stg}$ )	$T_{OPERATION} \leq T_{stg}$	- 40 ... +150 (125)	$^\circ\text{C}$
$V_{isol}$	AC, 1 min.	2500	V
<b>Inverse Diode</b>			
$I_{FAV} = -I_C$	$T_S = 25 (70)^\circ\text{C}$	390 (260)	A
$I_{FRM} = -I_{CM}$	$T_S = 25 (70)^\circ\text{C}$ , $t_p < 1$ ms	780 (520)	A
$I_{FSM}$	$t_p = 10$ ms; sin.; $T_j = 150^\circ\text{C}$	54450	A

Characteristics		$T_h = 25^\circ\text{C}$ , unless otherwise specified			
Symbol	Conditions	min.	typ.	max.	Units
<b>IGBT</b>					
$V_{GE(To)}$	$V_{GE} = V_{CE}$ , $I_C = 12$ mA	4,5	5,5	6,5	V
$I_{CES}$	$V_{GE} = 0$ , $V_{CE} = V_{CES}$ , $T_j = 25 (125)^\circ\text{C}$		0,4 (24)		mA
$V_{CE(To)}$			0,9 (0,8)	1,0	V
$r_{CE}$	$V_{GE} = 15$ V, $T_j = 25 (125)^\circ\text{C}$		2,0 (2,9)	2,7	m $\Omega$
$V_{CE(sat)}$	$I_C = 300$ A, $V_{GE} = 15$ V, $T_j = 25 (125)^\circ\text{C}$ on chip level		1,5 (1,7)	1,8	V
$C_{ies}$			35		nF
$C_{oes}$	$V_{GE} = 0$ , $V_{CE} = 25$ V, $f = 1$ MHz		3,75		nF
$C_{res}$			2,25		nF
$L_{CE}$				20	nH
$R_{CC'+EE'}$	resistance, terminal-chip $25 (125)^\circ\text{C}$		0,9 (1,1)		m $\Omega$
$t_{d(on)}$	$V_{CC} = 300$ V		140		ns
$t_r$	$I_C = 300$ A		110		ns
$t_{d(off)}$	$R_{Gon} = R_{Goff} = 6,2 \Omega$		750		ns
$t_f$	$T_j = 125^\circ\text{C}$		64		ns
$E_{on}$	$V_{GE} \pm 15$ V		16,5		mJ
$E_{off}$			11		mJ
<b>Inverse Diode</b>					
$V_F = V_{EC}$	$I_F = 300$ A; $V_{GE} = 0$ V; $T_j = 25 (125)^\circ\text{C}$ on chip level		1,25 (1,2)	1,5	V
$V_{TO}$	$T_j = 25 (125)^\circ\text{C}$		(0,85)	(0,9)	V
$r_T$	$T_j = 25 (125)^\circ\text{C}$		(1,33)	(2,0)	m $\Omega$
$I_{rrm}$	$I_F = 300$ A; $T_j = 125^\circ\text{C}$		230		A
$Q_{rr}$	$V_{GE} = 0$ V		28		$\mu\text{C}$
$E_{rr}$	$R_{Gon} = R_{Goff} = 6,2 \Omega$		5,2		mJ
<b>Thermal Characteristics</b>					
$R_{thjh}$	per IGBT			0,13	K/W
$R_{thjh}$	per FWD			0,19	K/W
<b>Temperature Sensor</b>					
$R_{TS}$	$T = 25^\circ\text{C} / 100^\circ\text{C}$		1,0 / 1,67		k $\Omega$
tolerance	$T = 25^\circ\text{C} / 100^\circ\text{C}$		3,0 / 2,0		%
<b>Mechanical Data</b>					
$M_1$	to heatsink (M5)			3	Nm
$M_2$	for terminals (M6)			5	Nm
w		2 4		325	g

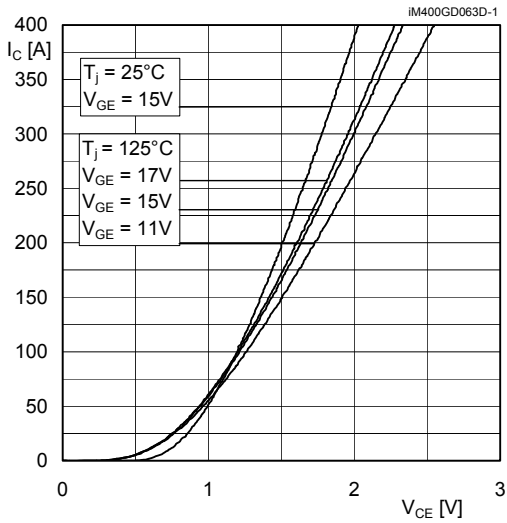

Fig. 1 Typ. output characteristic, inclusive  $R_{CC} + E_{E'}$

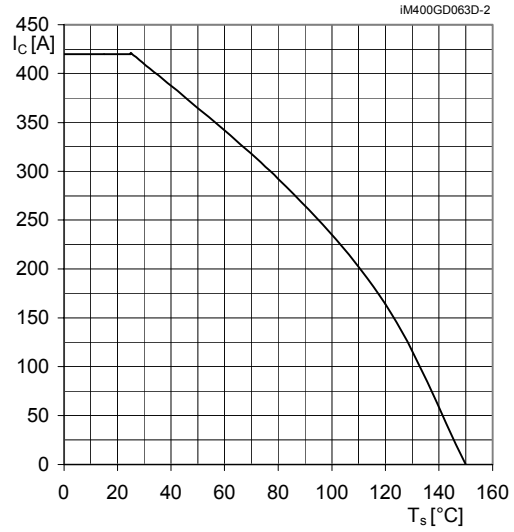

Fig. 2 Rated current vs. temperature  $I_C = f(T_S)$

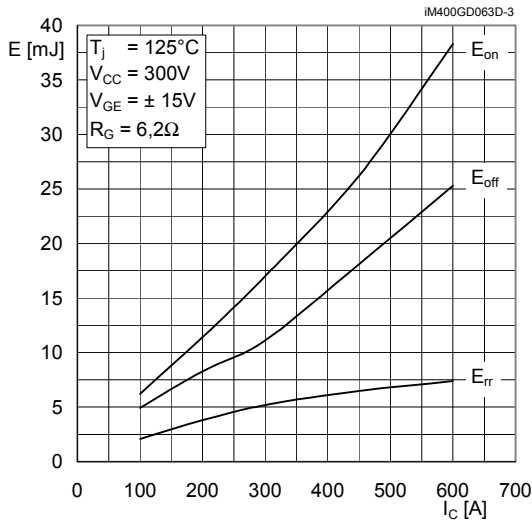

Fig. 3 Typ. turn-on /-off energy =  $f(I_C)$

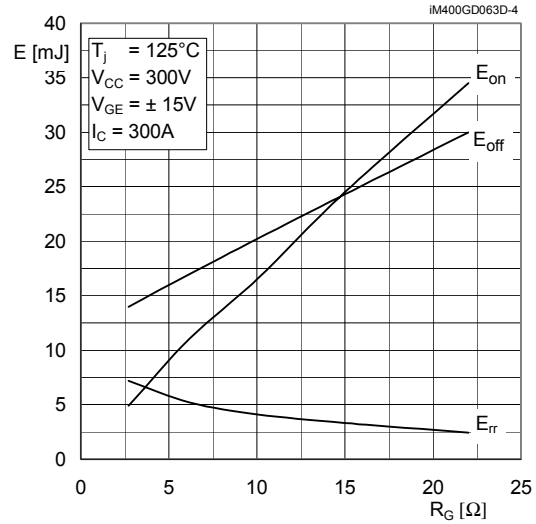

Fig. 4 Typ. turn-on /-off energy =  $f(R_G)$

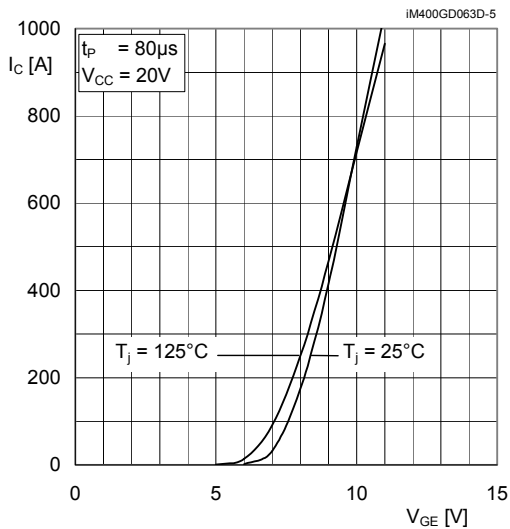

Fig. 5 Typ. transfer characteristic

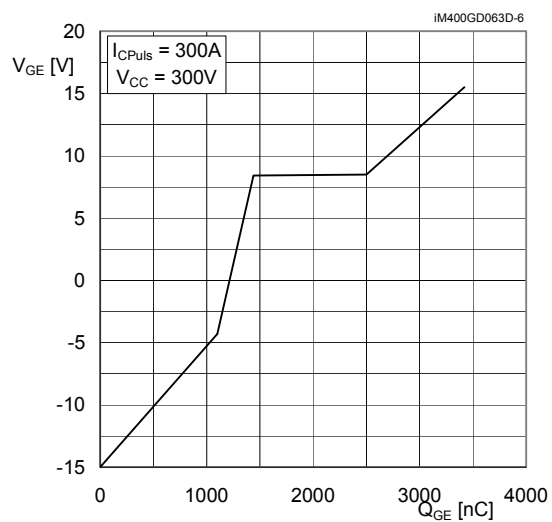

Fig. 6 Typ. gate charge characteristic

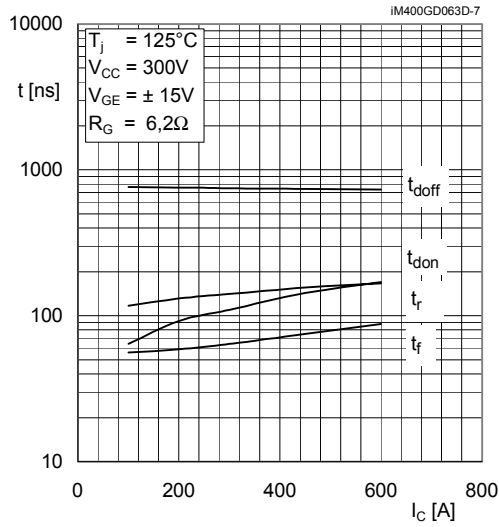

Fig. 7 Typ. switching times vs.  $I_C$

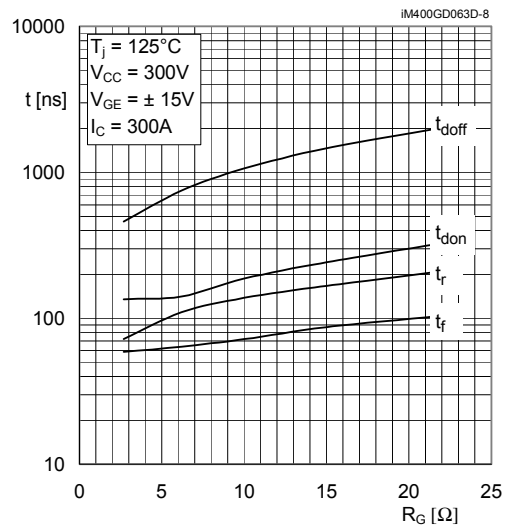

Fig. 8 Typ. switching times vs. gate resistor  $R_G$

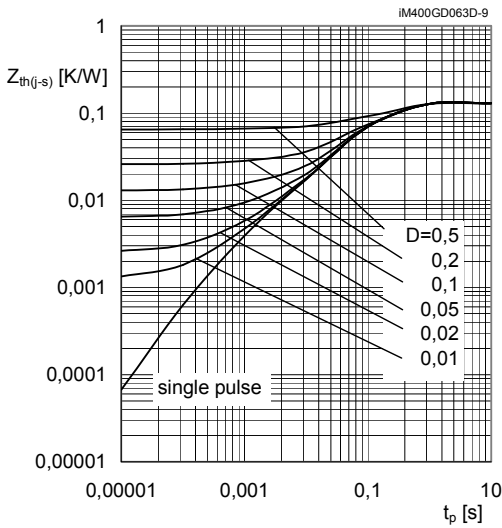

Fig. 9 Transient thermal impedance of IGBT  
 $Z_{thp(j-s)} = f(t_p)$ ;  $D = t_p / t_c = t_p \cdot f$

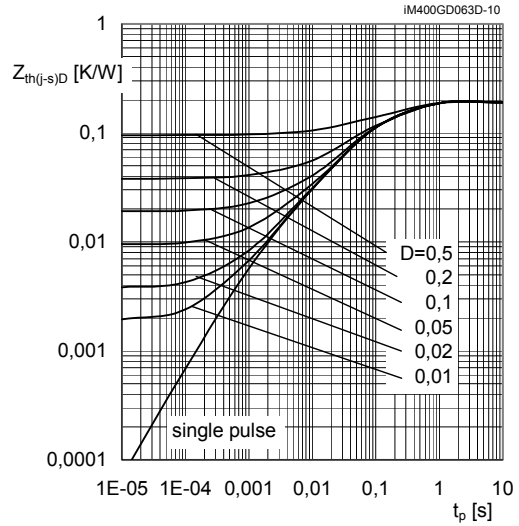

Fig. 10 Transient thermal impedance of FWD  
 $Z_{thp(j-s)D} = f(t_p)$ ;  $D = t_p / t_c = t_p \cdot f$

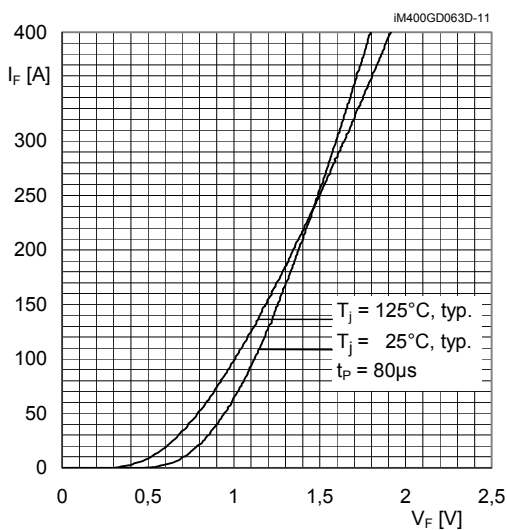

Fig. 11 CAL diode forward characteristic, inclusive  $R_{CC'+EE'}$

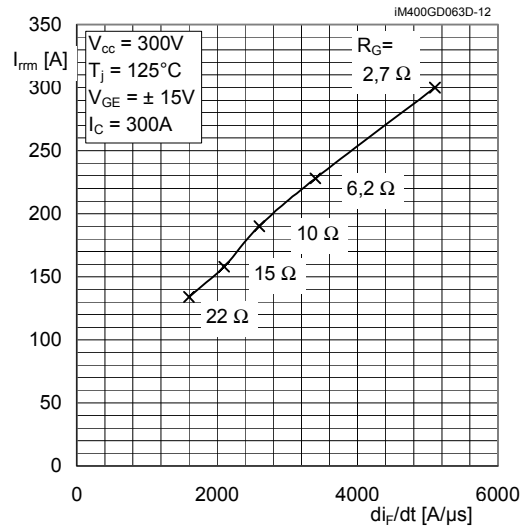
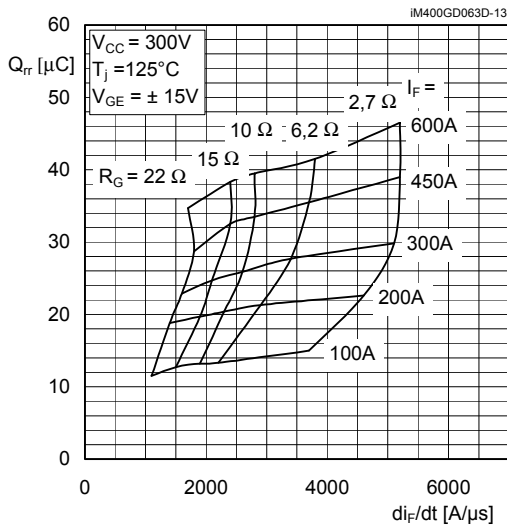

Fig. 12 CAL diode peak reverse recovery current



This is an electrostatic discharge sensitive device (ESDS).

Please observe the international standard IEC 747-1, Chapter IX.

Fig. 13 Typ. CAL diode recovered charge

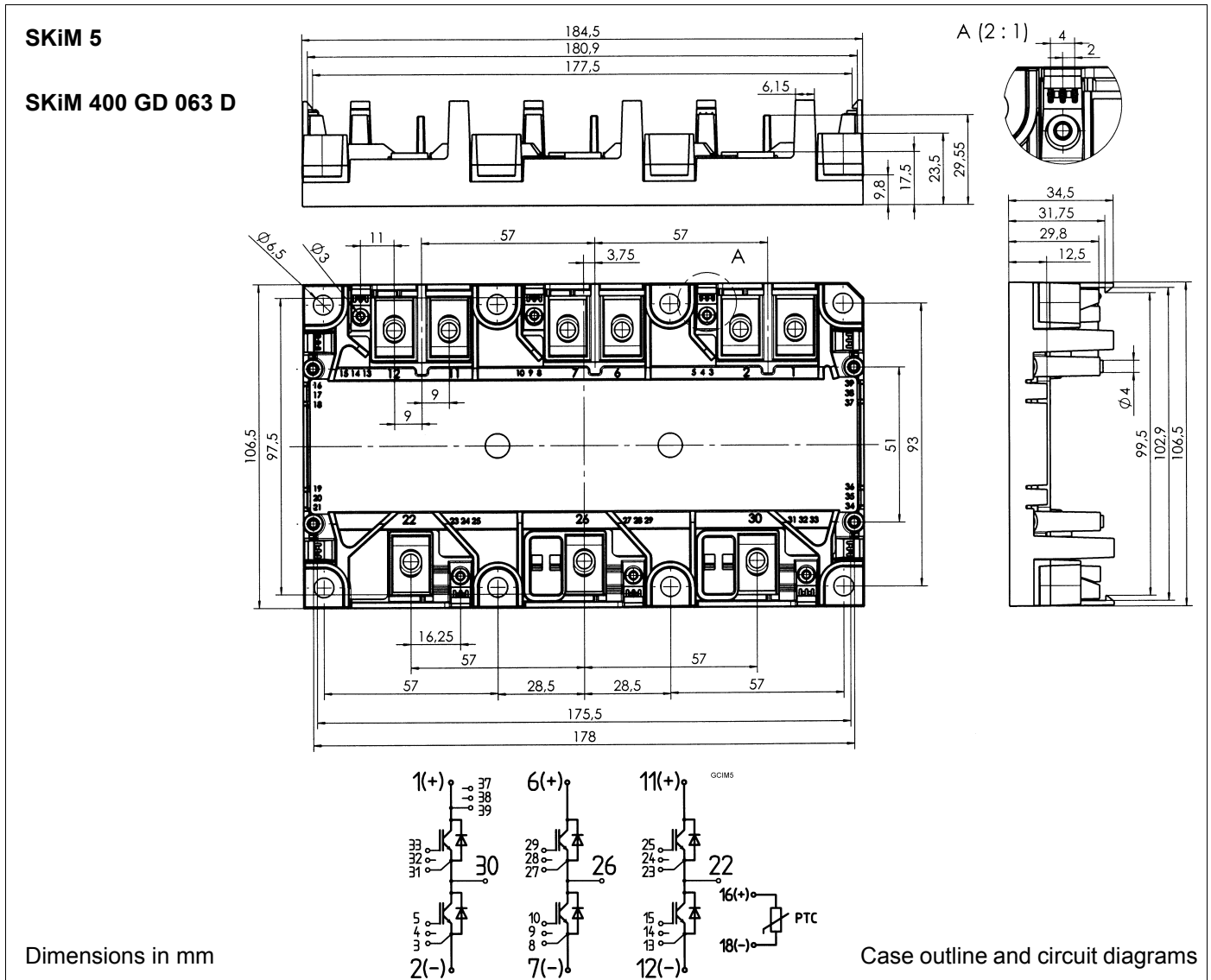

This technical information specifies semiconductor devices but promises no characteristics. No warranty or guarantee expressed or implied is made regarding delivery, performance or suitability.