

DTW8.12NG-8

Visaton 25 mm (1") HiFi fabric dome driver 8 Ohm

[BACK](#)



General description

25 mm (1") HiFi fabric dome driver with rectangular shaped front plate for the highrange above 2000 Hz. Coated dome with linear frequency response and strong magnetic drive for high efficiency. High power handling due to ferrofluid-filled air-gap. Suitable for 2- and 3-way combinations. Due to the front plate shaping especially suitable as replacement unit for many HiFi speakers.

Technical Data:

Nominal power handling with high pass	60 Watt (12 dB/Okt.; 2000 Hz)
Peak power handling with high pass	90 Watt (12 dB/Okt.; 2000 Hz)
Nominal impedance	8 Ohm
Frequency response (-10 dB)	1000 - 22000 Hz
Mean sound pressure level	90 dB (1W/1m)
Resonance frequency f_s	1500 Hz
Magnetic induction	1,6 Tesla
Magnetic flux	380 μ Weber
Voice coil diameter	2,5 cm
Cutout diameter	8 cm
Net weight	0,55 kg
D.C. resistance R_{dc}	5,6 Ohm
Mechanical Q factor Q_{ms}	1,1
Electrical Q factor Q_{es}	2,06
Total Q factor Q_{ts}	0,71
Effective piston area S_d	5 cm ²
Dynamically moved mass M_{ms}	0,3 g
Inductance of the voice coil L	0,05 mH

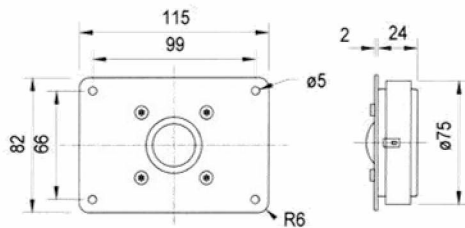

drawing

